

INTEL LGA 775/1150/1151/1155/1156



INTEL LGA 2011



1

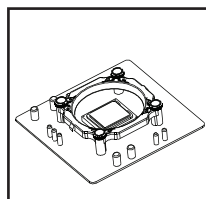
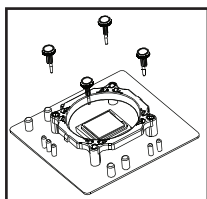
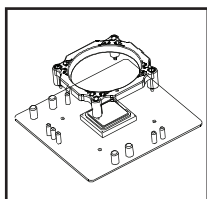
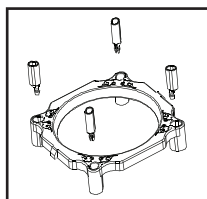

LGA 775

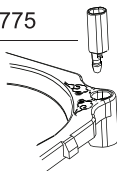

LGA 1150/1151/1155/1156

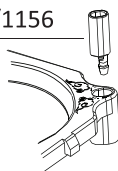

2

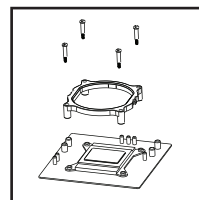

3

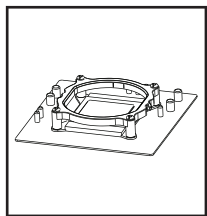

CPU

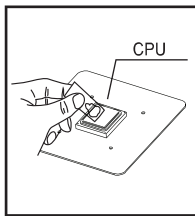

4

PLEASE USE AM4 SOCKET- BASE INCLUDED IN ACCESSORIES BAG FOR EXCHANGING IT ON AM4 MOTHERBOARD

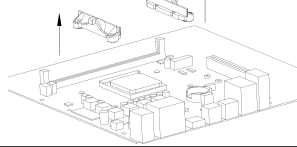

5

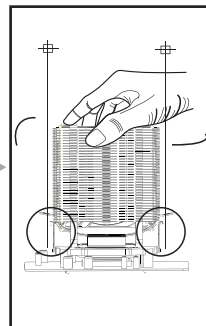
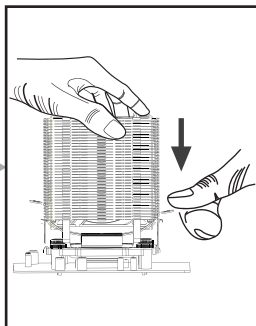
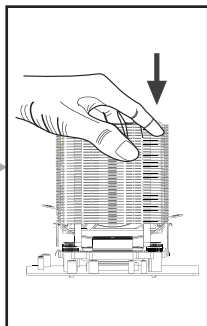
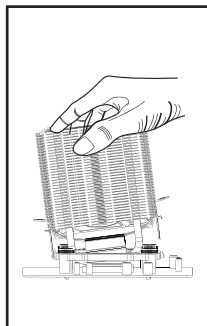

INTEL LGA 775/1150/1151/1155/1156:

1 → 3 → 5

INTEL LGA 2011:

2 → 3 → 5

AMD:

3 → 5

AM4:

3 → 4 → 5